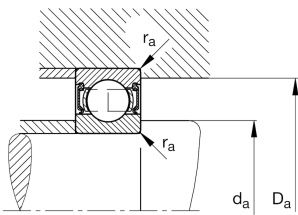

**FAG****S6200-2RSR-FD>N**

Deep groove ball bearing

Deep groove ball bearing S62...-2RSR-FD, corrosion-resistant materials, for Food industry, single row, seals, steel sheet metal cage

## Technical information

**Your current product variant**

Version code	>N	Not marked on bearing
Material Bearing	S	Stainless steel
Sealing	2RSR	Contact seal on both sides
Cage	JN	Steel sheet metal
Tolerance class	PN	Normal (PN)
Dimensional / heat stabilization	SN	Rings dimensional stabilized up to 120°
Lubricant	FD	Grease with food application approval to NSF H1
Radial internal clearance	CN (Group N)	Normal internal clearance
Bore type	Z	Cylindrical

**Main Dimensions & Performance Data**

d	10 mm	Bore diameter
D	30 mm	Outside diameter
B	9 mm	Width
C <sub>r</sub>	5.400 N	Basic dynamic load rating, radial
C <sub>0r</sub>	2.390 N	Basic static load rating, radial
C <sub>ur</sub>	148 N	Fatigue load limit, radial
n <sub>G</sub>	15.400 1/min	Limiting speed
≈m	32 g	Weight



### Mounting dimensions

$d_{a \min}$	14,2 mm	Minimum diameter shaft shoulder
$D_{a \max}$	25,8 mm	Maximum diameter of housing shoulder
$r_{a \max}$	0,6 mm	Maximum fillet radius

### Dimensions

$r_{\min}$	0,6 mm	Minimum chamfer dimension
$D_1$	23,8 mm	Shoulder diameter outer ring
$D_2$	25 mm	Caliber diameter outer ring
$d_1$	17,4 mm	Shoulder diameter inner ring

### Temperature range

$T_{\min}$	-30 °C	Operating temperature min.
$T_{\max}$	100 °C	Operating temperature max.

### Calculation factors

$f_0$	13,2	Calculation factor
-------	------	--------------------

### Characteristics

	Radial load
	Axial load in one direction
	Axial load in two directions
	Lifetime lubrication, freedom from maintenance
	Grease Lubrication
	Sealed on both sides
	Protected against rust