

**Elbow**  
**G-1/8-A/I**  
Part number: 3614

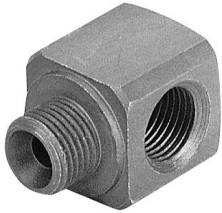

 [General operating condition](#)

**Data sheet**

Feature	Value
LABS (PWIS) conformity	VDMA24364-B1/B2-L
Pneumatic connection, port 1	G1/8
Pneumatic connection, port 2	G1/8
Note on materials	RoHS-compliant