

Male Elbow

SLM

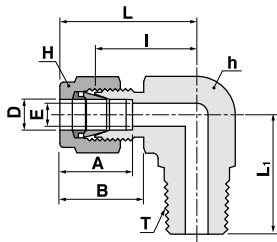

Connects metric tube to female ISO taper thread

Part No.	Tube O.D		T	E	Width across flat		A	B	I	L	L ₁
	D	R(PT)	Min.	h	H						
SLM-3M-2R	3	1/8	2.4	12.7	12	12.9	15.3	17.0	23.6	17.8	
SLM-3M-4R	3	1/4	2.4	12.7	12	12.9	15.3	18.0	24.6	23.4	
SLM-4M-2R	4	1/8	2.4	12.7	12	13.7	16.1	18.8	25.4	18.8	
SLM-4M-4R	4	1/4	2.4	12.7	12	13.7	16.1	18.8	25.4	23.4	
SLM-6M-2R	6	1/8	4.8	12.7	14	15.3	17.7	19.6	27.0	18.8	
SLM-6M-4R	6	1/4	4.8	12.7	14	15.3	17.7	19.6	27.0	23.4	
SLM-6M-6R	6	3/8	4.8	17.5	14	15.3	17.7	22.4	29.8	26.2	
SLM-6M-8R	6	1/2	4.8	20.6	14	15.3	17.7	24.4	31.8	33.0	
SLM-8M-2R	8	1/8	6.4	14.3	16	16.2	18.6	21.3	28.8	19.8	
SLM-8M-4R	8	1/4	6.4	14.3	16	16.2	18.6	21.3	28.8	24.4	
SLM-8M-6R	8	3/8	6.4	17.5	16	16.2	18.6	23.1	30.6	26.2	
SLM-8M-8R	8	1/2	6.4	20.6	16	16.2	18.6	25.1	32.6	33.0	
SLM-10M-2R	10	1/8	7.9	17.5	19	17.2	19.5	23.9	31.5	23.6	
SLM-10M-4R	10	1/4	7.9	17.5	19	17.2	19.5	23.9	31.5	26.2	
SLM-10M-6R	10	3/8	7.9	17.5	19	17.2	19.5	23.9	31.5	26.2	
SLM-10M-8R	10	1/2	7.9	20.6	19	17.2	19.5	25.9	33.5	33.0	
SLM-12M-2R	12	1/4	9.5	20.6	22	22.8	22.0	25.9	36.0	23.6	
SLM-12M-4R	12	1/4	9.5	20.6	22	22.8	22.0	25.9	36.0	28.2	
SLM-12M-6R	12	3/8	9.5	20.6	22	22.8	22.0	25.9	36.0	28.2	
SLM-12M-8R	12	1/2	9.5	20.6	22	22.8	22.0	25.9	36.0	33.0	
SLM-12M-12R	12	3/4	9.5	27.0	22	22.8	22.0	29.7	39.8	36.8	
SLM-16M-6R	16	3/8	12.7	23.8	25	24.4	22.0	27.9	38.0	30.2	
SLM-16M-8R	16	1/2	12.7	23.8	25	24.4	22.0	27.9	38.0	35.1	
SLM-16M-12R	16	3/4	12.7	27.0	25	24.4	22.0	29.7	39.8	36.8	
SLM-18M-8R	18	1/2	15.1	27.0	30	24.4	22.0	29.7	39.8	36.8	
SLM-18M-12R	18	3/4	15.1	27.0	30	24.4	22.0	29.7	39.8	36.8	
SLM-20M-8R	20	1/2	15.9	31.8	32	26.0	22.0	34.5	44.6	41.7	
SLM-20M-12R	20	3/4	15.9	31.8	32	26.0	22.0	34.5	44.6	41.7	
SLM-22M-12R	22	3/4	18.3	31.8	32	26.0	22.0	34.5	44.6	41.7	
SLM-22M-16R	22	1	18.3	34.9	32	26.0	22.0	34.5	44.6	46.5	
SLM-25M-12R	25	3/4	21.8	34.9	38	31.3	26.5	36.8	49.1	41.7	
SLM-25M-16R	25	1	21.8	34.9	38	31.3	26.5	36.8	49.1	46.5	