

Non-return valve, Series NR01

0821003003

Series NR01

- $Q_n = [40] \text{ l/min} \dots [7950] \text{ l/min}$



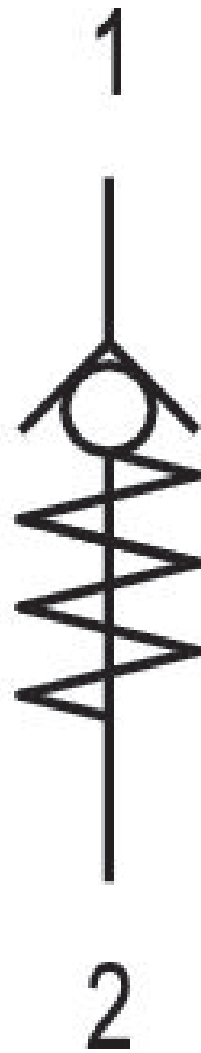

Technical data

Industry
Industrial

Compressed air connection 1
G 1/2

Compressed air connection type 1
Internal thread

Mounting
thread-in

Compressed air connection type 2
External thread

Type
Poppet valve

Compressed air connection 2
G 1/2

Nominal flow Qn 1 to 2
3500 l/min

Working pressure min.
0.2 bar

Working pressure max
10 bar

Min. ambient temperature
-10 °C

Max. ambient temperature
70 °C

Min. medium temperature
-10 °C

Max. medium temperature
70 °C

Medium
Compressed air

Weight
0.09 kg

Material

Housing material
Brass
Surface housing
nickel-plated

Seal material
Acrylonitrile butadiene rubber
Part No.
0821003003

Technical information

Fig. 1

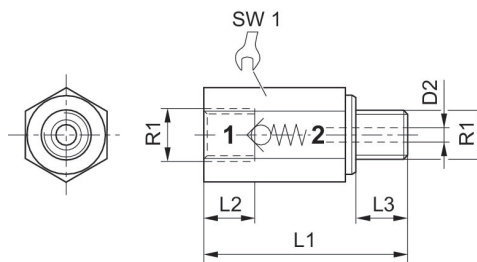

	R1	L1	L2	L3	D2	SW1
0821003005	M5	20	5	5	2	8

Fig. 2

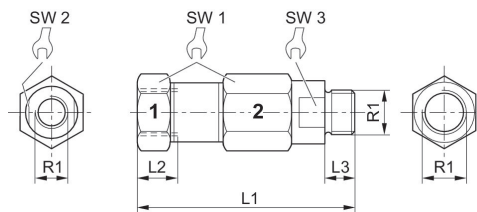

	R1	L1	L2	L3	SW1	SW2	SW3
0821003001	G 1/8	53	8	6	-	14	14
0821003002	G 1/4	66	12	9	19	-	17
0821003003	G 1/2	81	21	12	27	-	24