

# Distributor, Series AS2-DIS

## R412006251

### General series information Series AS2

- The AVENTICS Series AS2 is a modular, versatile maintenance unit for universal application. This Series offers compact dimensions, is highly efficient, lightweight and easy-to-use. The AVENTICS Series AS guarantees reliability, safety, and efficiency with a simplified assembly and maintenance efforts.

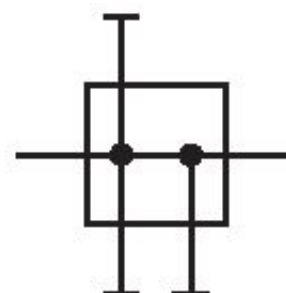

### Technical data

Industry  
Industrial

Type  
Can be assembled into blocks

Parts  
Distributor

Mounting orientation  
Any

Port  
G 3/8

Version  
Distributor 3x

Working pressure min.  
0 bar

Working pressure max  
16 bar

Min. ambient temperature  
-10 °C

Max. ambient temperature  
50 °C

Medium  
Compressed air  
Neutral gases

Nominal flow Qn  
3600 l/min

Nominal flow Qn 1 to 2  
3600 l/min

Nominal flow 1 # 3  
2000 l/min

Nominal flow Qn 1 to 4  
900 l/min

Nominal flow 1 # 5  
2000 l/min

Weight  
0.25 kg

Housing material  
Polyamide

Material front plate  
Acrylonitrile butadiene styrene

Seal material  
Acrylonitrile butadiene rubber

Material threaded bushing  
Die cast zinc  
R412006251

## Technical information

The pressure dew point must be at least 15 °C under ambient and medium temperature and may not exceed 3 °C .

Suitable for direct mounting of a PE2 and PM1 series pressure sensor (flange version).

A change in the flow direction (from air supply on the left to air supply on the right) occurs by rotating installation by 180° about the vertical axis. Please see the operating instructions for further details.

Nominal flow Qn with secondary pressure  $p_2 = 6 \text{ bar}$  at  $\Delta p = 1 \text{ bar}$

## Dimensions

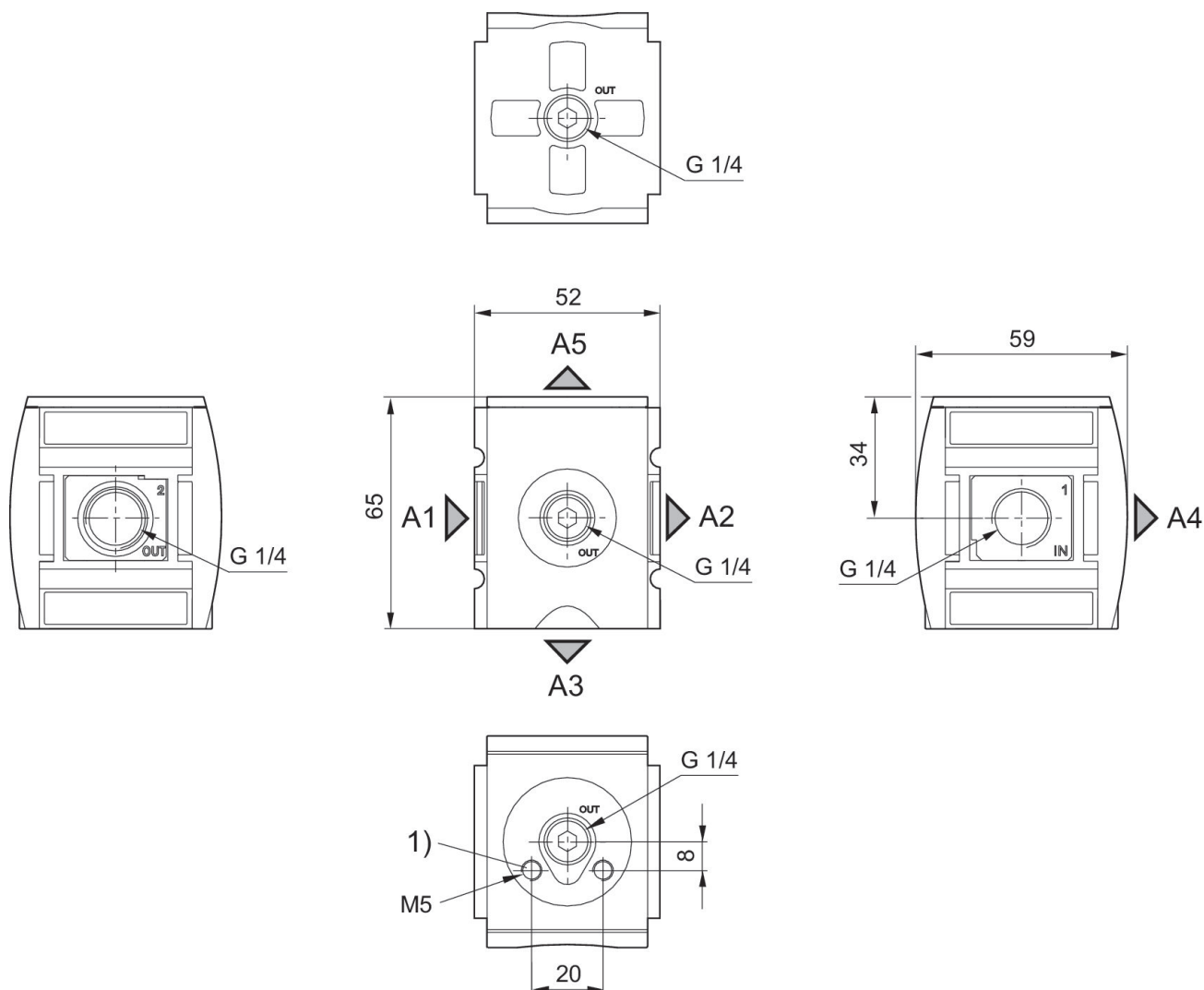

A1 = input A2 = output A3 = output A4 = output A5 = output  
1) Mounting thread for pressure sensor

## Dimensions in mm

Fig. 2

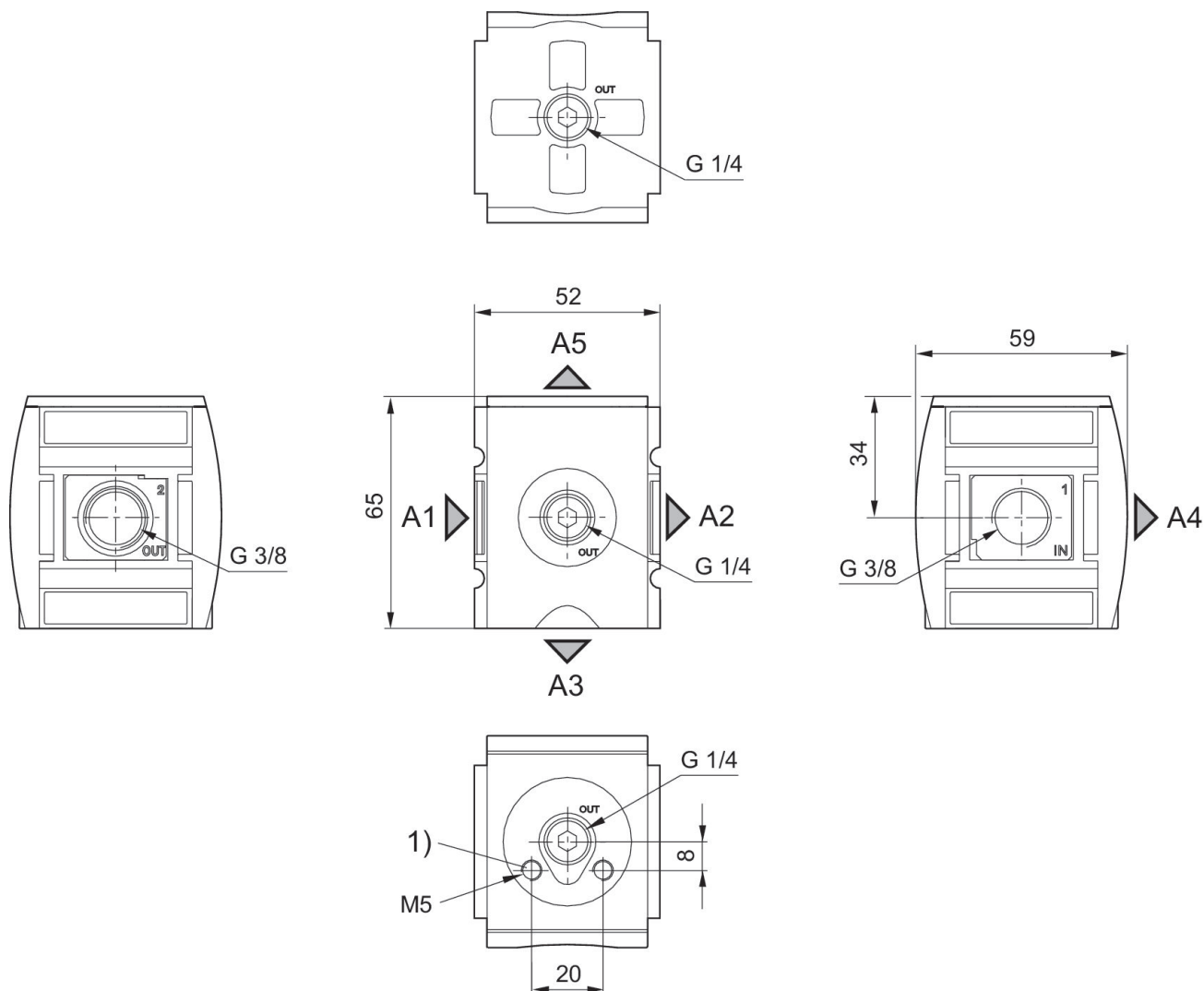

A1 = input A2 = output A3 = output A4 = output A5 = output  
1) Mounting thread for pressure sensor

## Accessories overview

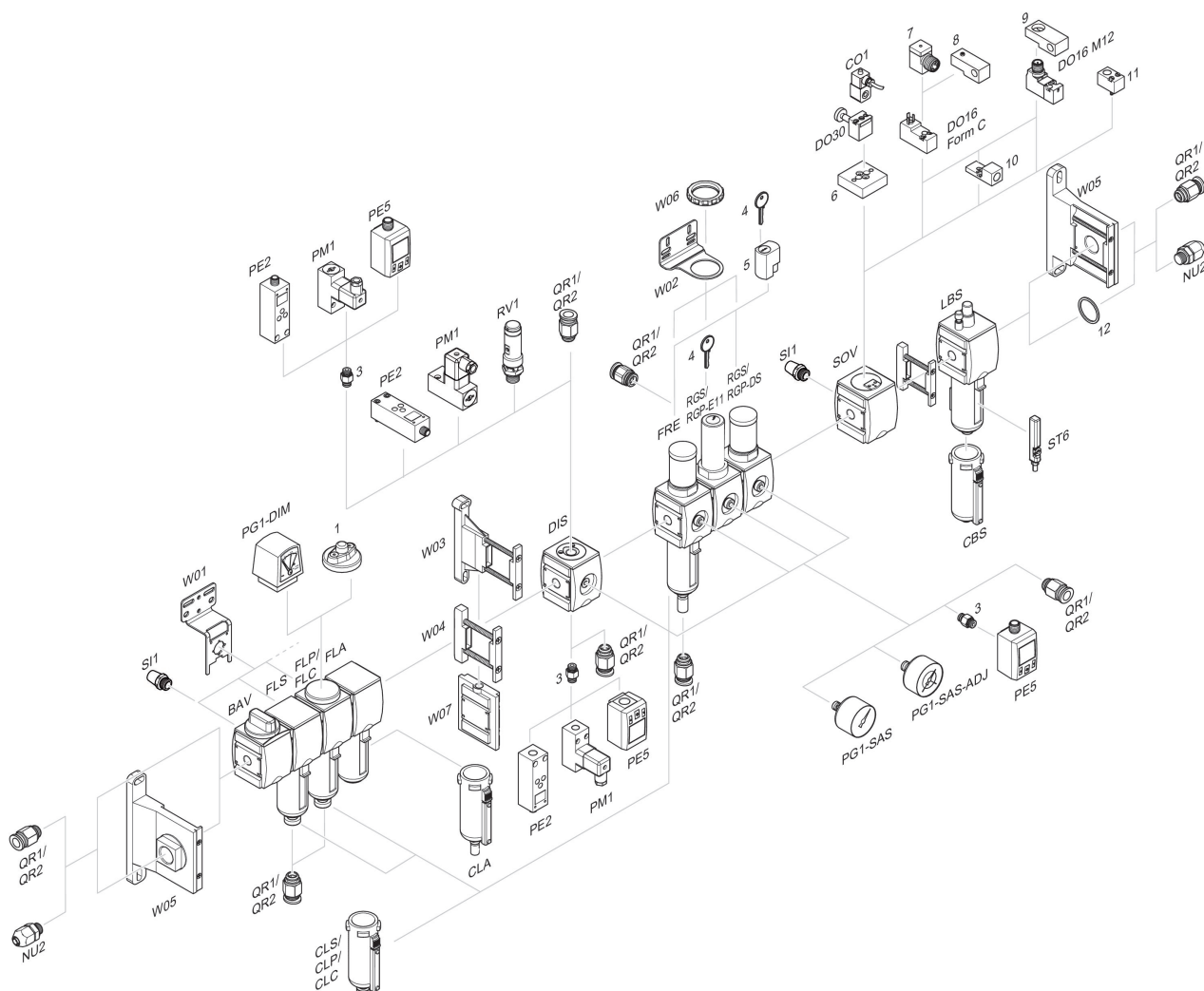

1 = contamination display 3 = Double nipple 4 = Key for E11 locking 5 = mortise lock 6 = Transition plate DO30 7 = Adapter, Series CON-VP 8 = Mounting aid DO16, form C 9 = Mounting aid DO16, M12 10 = Adapter for external pilot air 11 = Adapter pneumatic operation 12 = Sealing ring