



FAG

SES216-L

Plummer block housing

Schaeffler ID:
0860885480000

Split plummer block housing for various bearing designs. The SNV series will be replaced by the new SES series in 2022.

Technical information

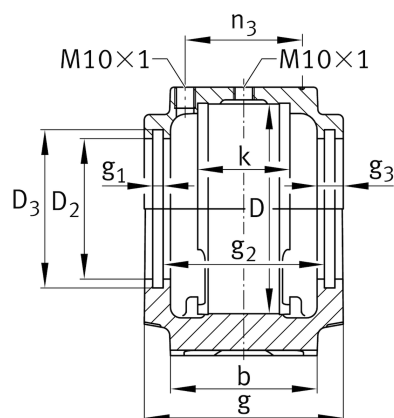
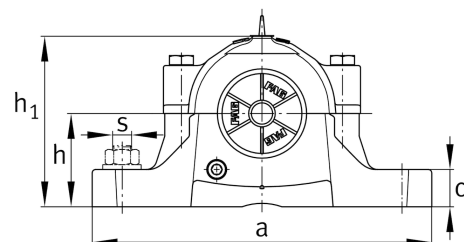
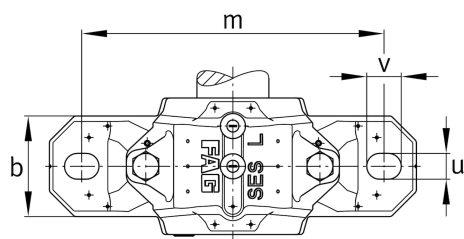

Main Dimensions & Performance Data

D	140 mm	Outside diameter bearing
a	315 mm	Length base
h ₁	177 mm	Height
g	120 mm	Width housing body
K	58 mm	Width bearing seat
	8,9 kg	Weight

Dimensions

b	90 mm	Width base
c	32 mm	Height base
h	95 mm	Base to shaft centerline height
m	260 mm	Distance fixing bore
s	19,05 mm	Screw size
s	M20	Size of fixing screws
u	22 mm	Width slot
v	28 mm	Length slot
D ₂	108 mm	Diameter sealing
D ₃	116,5 mm	Diameter sealing groove
D ₅	114,2 mm	Outside diameter sealing labyrinth
g ₁	5 mm	Width sealing groove
g ₂	102 mm	Distance sealing
g ₃	13 mm	Wall thickness
g ₄	36 mm	Distance oil lubrication
m ₁	218 mm	Distance holes aligned pins m1
n ₃	77 mm	Distance lubrication
n ₄	106 mm	Distance lubrication sealing
u ₁	8 mm	Bore diameter u1
u ₂	18 mm	Bore diameter u2

