



FAG

SES212-L

Plummer block housing

Schaeffler ID:
0860884830000

Split plummer block housing for various bearing designs. The SNV series will be replaced by the new SES series in 2022.

Technical information

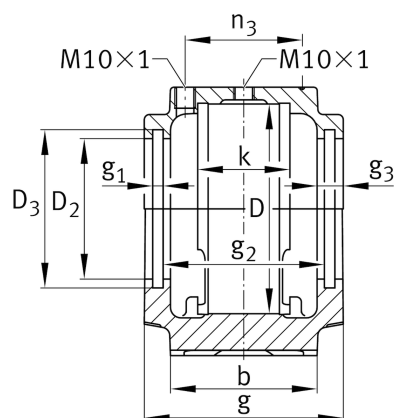
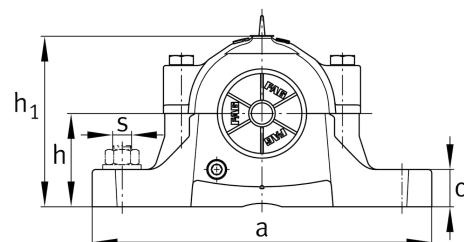
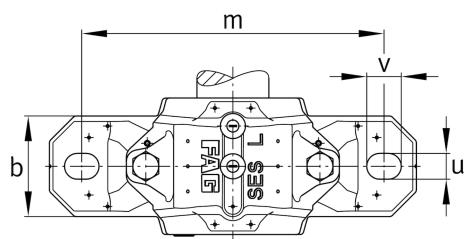

Main Dimensions & Performance Data

D	110 mm	Outside diameter bearing
a	255 mm	Length base
h ₁	134 mm	Height
g	105 mm	Width housing body
K	48 mm	Width bearing seat
	4,82 kg	Weight

Dimensions

b	70 mm	Width base
c	30 mm	Height base
h	70 mm	Base to shaft centerline height
m	210 mm	Distance fixing bore
s	15,875 mm	Screw size
s	M16	Size of fixing screws
u	18 mm	Width slot
v	24 mm	Length slot
D ₂	87 mm	Diameter sealing
D ₃	95,5 mm	Diameter sealing groove
D ₅	93,2 mm	Outside diameter sealing labyrinth
g ₁	5 mm	Width sealing groove
g ₂	87 mm	Distance sealing
g ₃	12 mm	Wall thickness
g ₄	37 mm	Distance oil lubrication
m ₁	174 mm	Distance holes aligned pins m1
n ₃	62 mm	Distance lubrication
n ₄	90 mm	Distance lubrication sealing
u ₁	6 mm	Bore diameter u1
u ₂	14 mm	Bore diameter u2

