

Orifice range: 11,2mm - 25mm

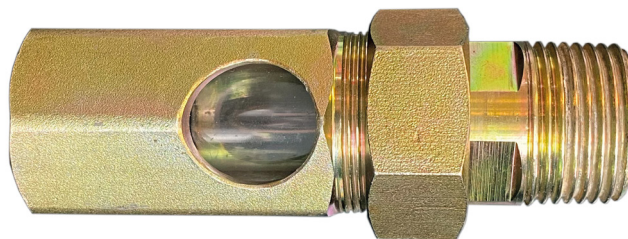

This union restriction orifice with sight glass is a conveniently usable threaded union pipe fitting and is mostly applied in a sprinkler piping test-line on alarm post or at end-of line. Orifice size has to be selected to order.

Characteristics

- Sight glass for sprinkler pipe testing purposes.
- Easy use 1" male / female union fitting with rubber gasket sealing.
- Incorporated restriction orifice.
- Generally used for cold water applications. For other media please check suitability.

Working pressure

Maximum 21 bar / 300 psi



Working temperature

Maximum 50°C

Materials

- Body, nut & orifice: electroplated carbon steel C22E.
- Sight glass: PMMA.
- Rubber gasket: EPDM rubber.

Dimensions

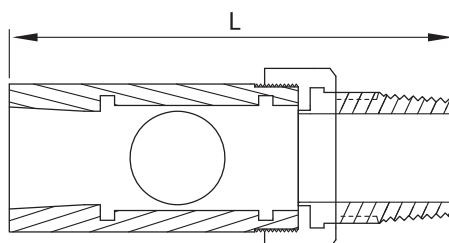

TYPE	SIZE ORIFICE	THREAD BSPT	TOTAL LENGTH MM	K-FACTOR US *	K-FACTOR METRIC *
KGU-11	D. 11,2 MM	1"	110	4.2	60
KGU-13	D. 13 MM	1"	110	5.6 - 8.0	80 - 115
KGU-16	D. 16 MM	1"	110	11.2	160
KGU-20	D. 20 MM	1"	110	14	200
KGU-25	D. 25 MM	1"	110	16.8	240

* Values taken from table A.7.2.2.1 - NFPA13(2022)

GENERAL INFO

- Installers should be trained or experienced to install and understand the product.
- Read and understand all technical datasheets and installation instructions before attempting to install, remove or adjust any Profit piping products.
- Depressurise and drain the sprinkler installation system before attempting to install, remove or adjust any Profit piping products.
- Never work on piping-systems that are pressurised and / or filled with water.
- Use the necessary Personal Protection Equipment (PPE) to avoid personal injury (helmet, safety shoes and goggles, Profit gloves).



Failure to follow these instructions could result in death or serious injury and property damage.

We advise to always store our products in closed and dry environments, the products do not need any specific maintenance once installed on an aboveground sprinkler installation.

REVISION TABLE

Date	△	Notes
25/04/2024	A	Page 1 - Working temperature is changed to 50°C.