

FAG

**S6307-2RSR-FD**

Deep groove ball bearing

Schaeffler ID:  
0947141770000

Deep groove ball bearing S63...-2RSR-FD, corrosion-resistant materials, for Food industry, single row, seals, steel sheet metal cage

## Technical information

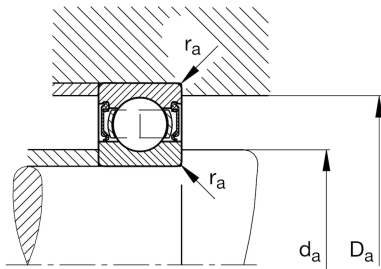
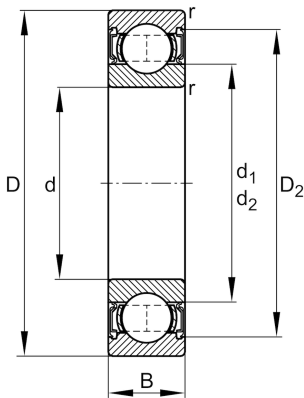
**Main Dimensions & Performance Data**

d	35 mm	Bore diameter
D	80 mm	Outside diameter
B	21 mm	Width
C <sub>r</sub>	28.300 N	Basic dynamic load rating, radial
C <sub>0r</sub>	15.400 N	Basic static load rating, radial
C <sub>ur</sub>	1.680 N	Fatigue load limit, radial
n <sub>G</sub>	3.600 1/min	Limiting speed
≈m	0,483 kg	Weight

**Mounting dimensions**

d <sub>a min</sub>	44 mm	Minimum diameter shaft shoulder
D <sub>a max</sub>	71 mm	Maximum diameter of housing shoulder
r <sub>a max</sub>	1,5 mm	Maximum fillet radius

**Dimensions**

r <sub>min</sub>	1,5 mm	Minimum chamfer dimension
D <sub>2</sub>	71,58 mm	Caliber diameter outer ring
d <sub>2</sub>	46,8 mm	Caliber diameter inner ring

**Temperature range**

T <sub>min</sub>	-30 °C	Operating temperature min.
T <sub>max</sub>	100 °C	Operating temperature max.

**Calculation factors**

f <sub>0</sub>	10,6	Calculation factor
----------------	------	--------------------