



FAG

**SES516-613-L**

Plummer block housing

Schaeffler ID:  
0860885560000

Split plummer block housing for various bearing designs. The SNV series will be replaced by the new SES series in 2022.

## Technical information

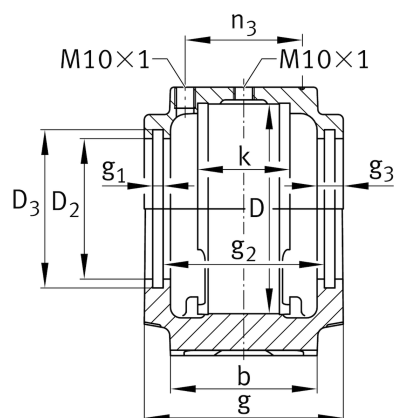
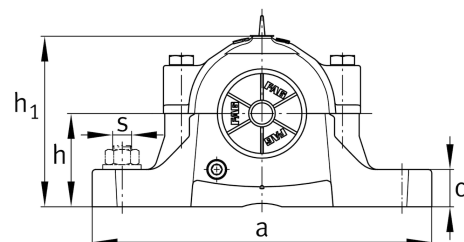
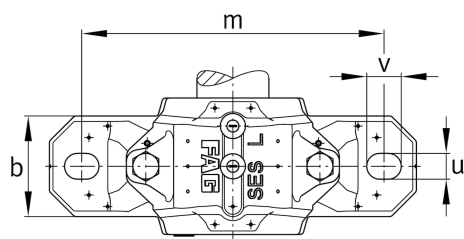
**Main Dimensions & Performance Data**

D	140 mm	Outside diameter bearing
a	315 mm	Length base
h <sub>1</sub>	177 mm	Height
g	120 mm	Width housing body
K	58 mm	Width bearing seat
	9,3 kg	Weight

**Dimensions**

b	90 mm	Width base
c	32 mm	Height base
h	95 mm	Base to shaft centerline height
m	260 mm	Distance fixing bore
s	19,05 mm	Screw size
s	M20	Size of fixing screws
u	22 mm	Width slot
v	28 mm	Length slot
D <sub>2</sub>	92,5 mm	Diameter sealing
D <sub>3</sub>	101 mm	Diameter sealing groove
D <sub>5</sub>	98,7 mm	Outside diameter sealing labyrinth
g <sub>1</sub>	5 mm	Width sealing groove
g <sub>2</sub>	102 mm	Distance sealing
g <sub>3</sub>	13 mm	Wall thickness
g <sub>4</sub>	36 mm	Distance oil lubrication
m <sub>1</sub>	218 mm	Distance holes aligned pins m1
n <sub>3</sub>	77 mm	Distance lubrication
n <sub>4</sub>	106 mm	Distance lubrication sealing
u <sub>1</sub>	8 mm	Bore diameter u1
u <sub>2</sub>	18 mm	Bore diameter u2

