



FAG

## SES517-L

Plummer block housing

Schaeffler ID:  
0860885720000

Split plummer block housing for various bearing designs. The SNV series will be replaced by the new SES series in 2022.

## Technical information

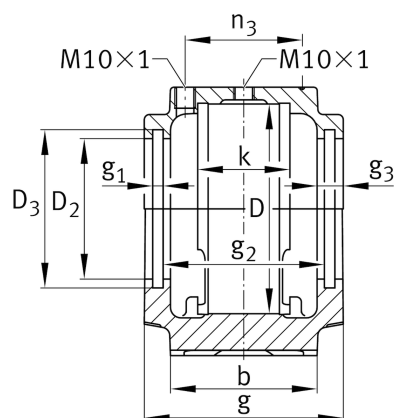
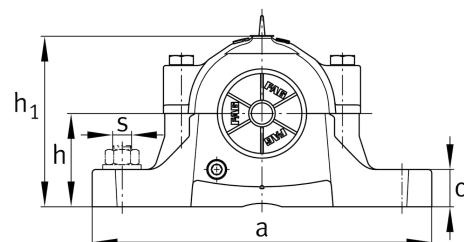
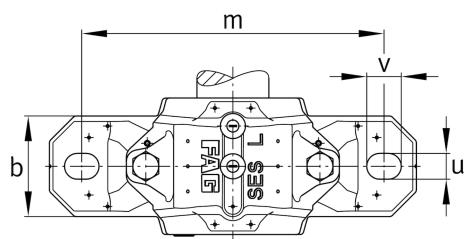

## Main Dimensions &amp; Performance Data

D	150 mm	Outside diameter bearing
a	320 mm	Length base
h <sub>1</sub>	183 mm	Height
g	125 mm	Width housing body
K	61 mm	Width bearing seat
	9,9 kg	Weight

## Dimensions

b	90 mm	Width base
c	32 mm	Height base
h	95 mm	Base to shaft centerline height
m	260 mm	Distance fixing bore
s	19,05 mm	Screw size
s	M20	Size of fixing screws
u	22 mm	Width slot
v	28 mm	Length slot
D <sub>2</sub>	97,5 mm	Diameter sealing
D <sub>3</sub>	106 mm	Diameter sealing groove
D <sub>5</sub>	103,7 mm	Outside diameter sealing labyrinth
g <sub>1</sub>	5 mm	Width sealing groove
g <sub>2</sub>	107 mm	Distance sealing
g <sub>3</sub>	13 mm	Wall thickness
g <sub>4</sub>	32 mm	Distance oil lubrication
m <sub>1</sub>	220 mm	Distance holes aligned pins m1
n <sub>3</sub>	80 mm	Distance lubrication
n <sub>4</sub>	111 mm	Distance lubrication sealing
u <sub>1</sub>	8 mm	Bore diameter u1
u <sub>2</sub>	18 mm	Bore diameter u2

